

插销桁架系列
Quick Mount Series

TD-QC46S-50

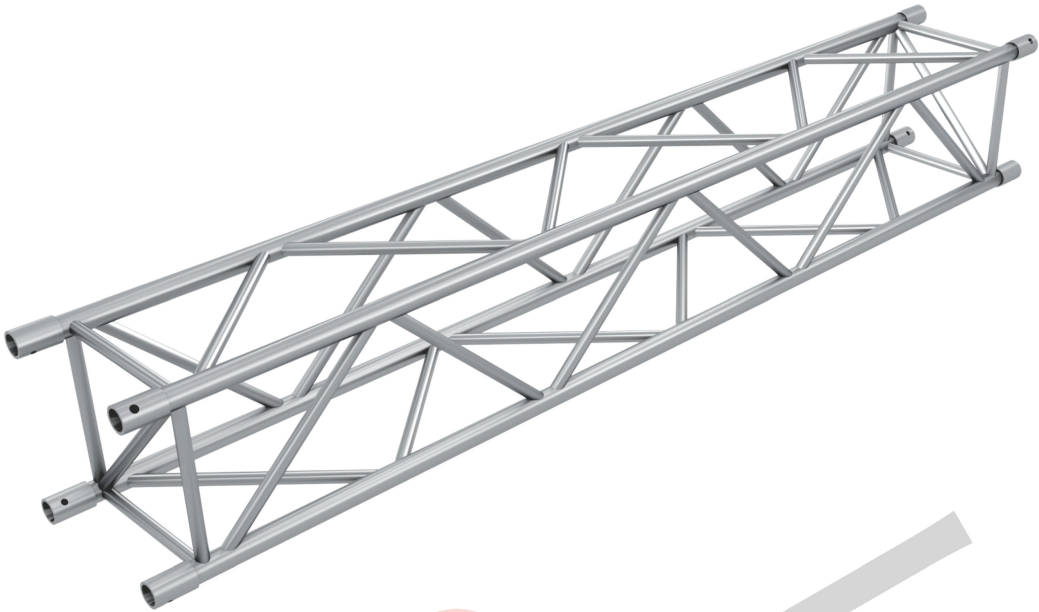

俯视图
Top view

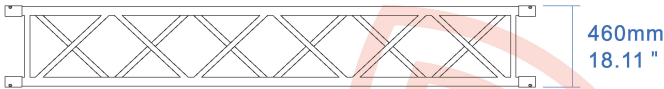

侧视图
Side view

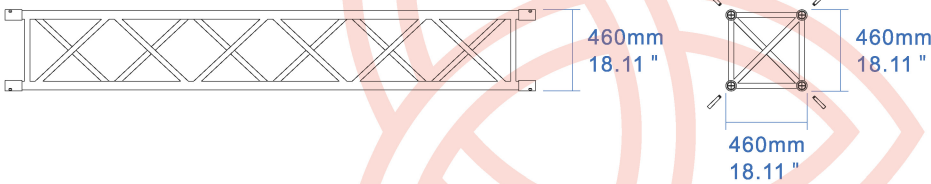

规格 Dimensions		
形状 Shape	正方形 Square	正方形 Square
材质 Material	EN AW 6082 T6	EN AW 6082 T6
主管 Main Tubes	50 x 3 mm Cross Pipe (十字芯)	1.97 x 0.12 in Cross Pipe (十字芯)
副管 Braces	30 x 3 mm	1.18 x 0.12 in
重量 Weight	≈ 9.36 kg/m	≈ 6.30 lbs/ft
1 inch = 25.4 mm 1 m = 3.28 ft 1 lbs = 0.453kg		

TD-QC46S-50 铝合金桁架允许荷载表
ALLOWABLE LOADING

跨度 SPAN		平均分布荷载UDL Uniformly Distributed Load		下垂值 DEFLECTION		中心点荷载CPL Centre Point Load		下垂值 DEFLECTION		三段单点荷载TPL single load third points		四段单点荷载QPL single load fourth points		五段单点荷载FPL single load fifth points		自重 total weight
m	ft	kg/m	lbs/ft	mm	inch	kg	lbs	mm	inch	kg	lbs	kg	lbs	kg	lbs	kg
4	13.1	2125	1430.2	2.5	0.098	7110	15695.4	4.2	0.165	5265	11622.5	3525	7781.5	2950	6512.1	37.4
8	26.2	950	639.4	13.5	0.531	3865	8532.0	15.2	0.598	3200	7064.0	2285	5044.2	1685	3719.7	74.8
12	39.4	310	208.6	19.2	0.756	2385	5264.9	23.6	0.929	1785	3940.4	1380	3046.4	1020	2251.7	112.2
16	52.5	192	129.2	28.3	1.114	1565	3454.8	30.2	1.189	1285	2836.6	954	2106.0	772	1704.2	149.6
20	65.6	78	52.5	38.2	1.504	940	2075.1	40.3	1.587	765	1688.7	620	1368.7	465	1026.5	187.0
24	78.7	43	28.9	56.3	2.217	600	1324.5	58.5	2.303	495	1092.7	390	860.9	285	629.1	224.4
1 inch = 25.4 mm 1 m = 3.28 ft 1 lbs = 0.453kg																

- 加载数据只适用于静态负荷和两个支撑点。
- 表中所列荷载均为恒荷载，未考虑动力系数。
- 加载数据基于BS-7905-2/ANSI E1.2-2006/CWA 15902-2, GB/T5237。在考虑安全因素时，加载数据应增加0.8。
- 桁架的自重已考虑。
- 适用桁架高度460mm, 弦杆为Φ50*3mm十字芯圆管, 腹杆为Φ30*3mm圆管。
- 特别注意: 超过20米的结构，如果由多个部分组合起来而构成的总长度，将会造成10 - 15%弯曲的可能性(在同等荷载的条件下)。允许偏差，负载数据不变。
- Loading figures only valid for static loads and spans with two supporting points.
- Spans must be supported at each end.
- If dynamic loads or wind loads are involved, or more supporting points are applied, contact Trinity Customer Service for details.
- Loading figures are based on BS 7905-2/ANSI E1.2-2006/CWA 15902-2, GB/T5237. The loading data should multiply 0.8 for Safety factor consideration.
- The self-weight of the trusses has already been taken into account.
- Suitable for trusses with design height of 460mm. Main tubing Φ 50 * 3mm with cross insert, brace tubing Φ 30 * 3mm.
- Special attention to structure over 20m, if multiple sections combined to make up the total length: Additional Reflection 10 to 15%deflection should be allowed, the allowable loading unchanged.